



Hat Mounting Guide

1. Slide the hat mounting clips upwards onto the side of the hat. Repeat for both sides.

2. Fold the inner hat band over the clip tabs to lock into place. Repeat for both sides.

3. Mount the device over the hat, pressing the tabs into the slots.



Click to mount.



Pinch to release.

4. Slide the back of the hat into the rear clip marked in blue to secure the device.

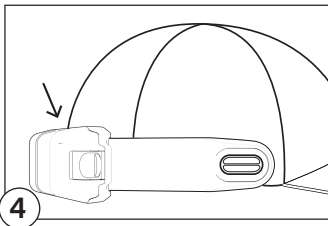
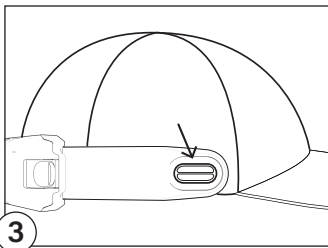
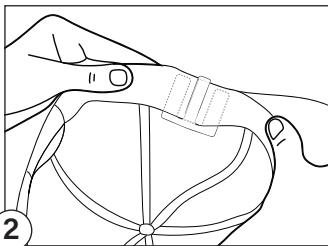
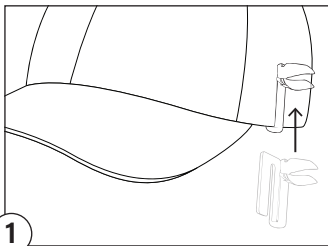

For more information on Vuzix products and accessories visit:

vuzix.com | vuzix.jp

Vuzix Corporation
25 Hendrix Road
West Henrietta, NY, USA 14586

© 2025 Vuzix Corporation. These instructions are subject to change. Please read the Safety and Warranty booklet before operating this product. All trademarks belong to the respective owners.

516PB0006 (0001) - LX1 HAT MOUNTING GUIDE



516PB0006-0001